

Exposed Bath Mixer with Divertor

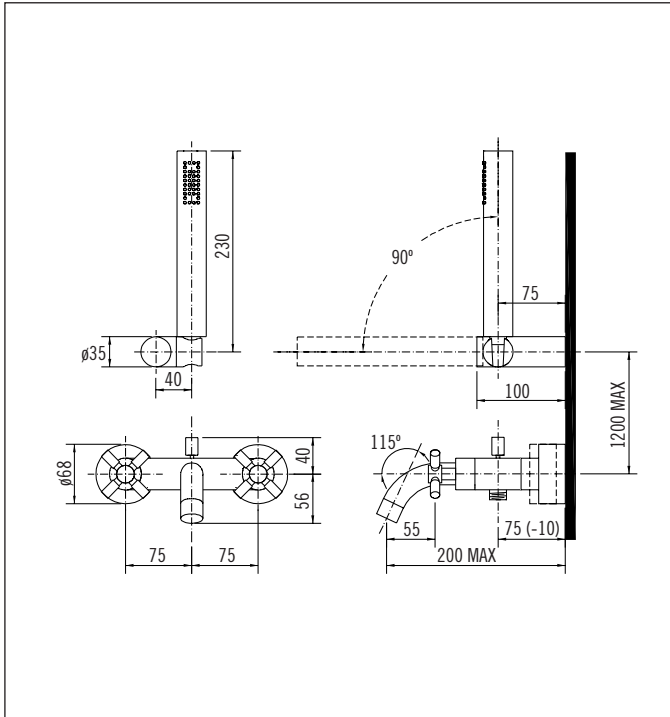

Code: MK XBM15/20 CP
 Finish: Chrome
 Mechanism: 2 x 90° right hand ceramic

Supplied with Aerator, Aerator spanner, 3mm hex key and eccentrics spanner

Comes with narrow bore metal hose, wand style handshower head and wall bracket

Supplied with concealed eccentrics 150mm ± 18mm

Wingbacks in wall must be within 18mm of 150mm centre to centre, and between flush and 15mm recessed

Installation Hole Diameter: Minimum: 21mm
 Maximum: 40mm
 Recommended: 25mm

Handy Tip: To remove handle, unscrew all 4 spokes of the handle.

Mains pressure only

Recommended Pressure

Operational Range:

Minimum: 150 kPa

Recommended: 600 kPa

Never to Exceed: 1000 kPa

Maximum Operating

Temperature: 70°C

Aquatica Warranty

Aquatica NZ Limited offer, from the date of purchase, a 2 year warranty on handshowers, a 5 year warranty on tapware and accessories and a lifetime warranty on stainless steel sinks.

Aquatica NZ Limited warrants that only high quality workmanship and materials have been employed in the manufacture of its tapware, accessories and stainless steel products. If any faulty workmanship or materials is proven during the warranty period, Aquatica NZ Limited will at its own cost repair, or at its option replace, the faulty product. The guarantee is non-transferable and proof of purchase is required.

The use of spray or abrasive cleaners of any kind will void the warranty. (Tapware should only be cleaned with a mild detergent and a soft damp cloth).

Failure to use an in-line strainer or filter on lines to tapware incorporating a ceramic cartridge or ceramic disc mechanism will also void the warranty. In the Bay of Plenty (or any area with a high mineral content) failure to install a 1 micro carbon block cartridge may void the warranty.

Every effort has been made to show the products as they will be sold, however, all models and specifications are subject to change without notice.